

THIS DOCUMENT AND THE INFORMATION IT CONTAINS IS THE PROPERTY OF EMTEQ INC. AND MAY NOT BE USED IN ANY WAY WITHOUT THE EXPRESS WRITTEN CONSENT OF EMTEQ INC.

REV	REVISION	DATE	ER #	INTL
D	CLARIFY CALLOUT OF GOLD CRIMP TUBE	12/13/2207	7849	VML
E	ADD CONNECTORS TFS295-1 & TFS410-1	9/18/2008	8897	LLP
F	CHG DIM "A" FOR TFS295, TFS340 & TFS410	04/14/2009	9599	VML
G	CHANGE P/N OF ITEM 5, HEATSHRINK	10/28/2009	10252	VML

DIMENSIONAL INFORMATION

PART NO.	"A"	"B"	"C"	ASSEMBLY INSTRUCTIONS
TFS130-1	1.41 (35.8)	0.46 (11.7)	0.22 (5.6)	ES-105-3
TFS165-1	1.41 (35.8)	0.46 (11.7)	0.25 (6.4)	ES-105-3
TFS195-1	1.33 (33.8)	0.46 (11.7)	0.25 (6.4)	ES-105-3
TFS205-1	1.41 (35.8)	0.46 (11.7)	0.30 (7.6)	ES-105-3
TFS225-1	1.33 (33.8)	0.46 (11.7)	0.30 (7.6)	ES-105-3
TFS240-1	1.33 (33.8)	0.46 (11.7)	0.30 (7.6)	ES-105-3
TFS295-1	1.59 (40.4)	0.56 (14.2)	0.39 (9.9)	ES-105-7
TFS340-1	1.59 (40.4)	0.56 (14.2)	0.39 (9.9)	ES-105-7
TFS410-1	1.59 (40.4)	0.46 (11.7)	0.39 (9.9)	ES-105-7

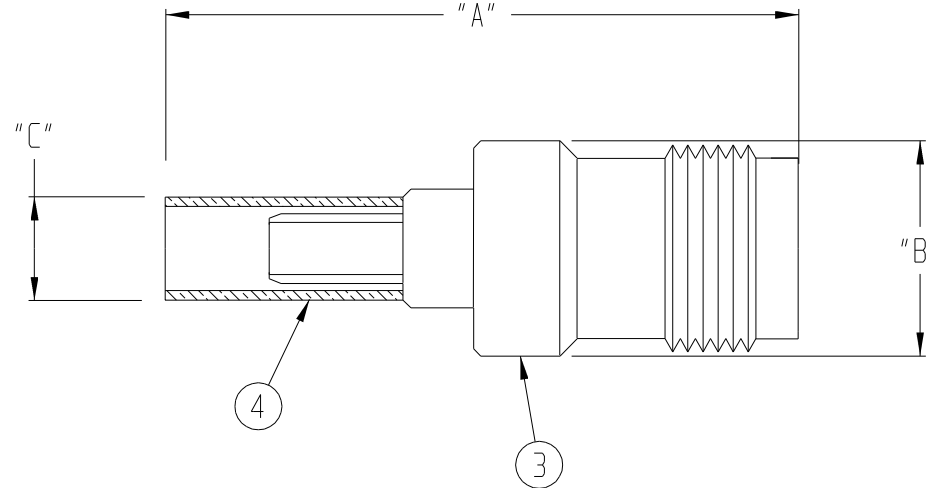

SPECIFICATIONS:

- ELECTRICAL
 - IMPEDANCE: 50 OHMS
 - FREQUENCY RANGE: 0 TO 4 GHZ
 - VOLTAGE RATING: 500 V RMS
 - DIELECTRIC WITHSTANDING VOLTAGE: 1,500 V RMS
 - INSULATION RESISTANCE: 5,000 MEGOHMS MIN

2) MECHANICAL

TERMINATION STYLE: INNER CONTACT - SOLDER
OUTER CONTACT - CRIMP

TEMPERATURE RANGE: -65° C TO + 165° C

FINISHES:

BODY FINISH: PROPRIETARY NICKEL

CONTACT FINISH: GOLD PLATED PER MIL-G-45204

DESIGNED IN ACCORDANCE WITH MIL-C-39012 STANDARDS.

410-1	340-1	295-1	240-1	225-1	205-1	195-1	165-1	130-1	PART NUMBER	DESCRIPTION	ITEM
									ATUM 1/2 BLK	DURABLE HEATSHRINK	5
									29-174-2		
									29-100-4/29-100-74		
									29-141-2		
									29-100-4/29-100-74		
									29-100-63		
									29-137-2		
									29-138-2		
									29-140-2/29-140-4	CRIMP TUBE	4
									29-100-68		
									29-100-12		
									09-221-1		
									09-221-2		
									09-221-3	BODY	3
									09-222-1		
									09-221-4		
									06-368-19		
									06-368-17		
									06-368-11	CONTACT	2
									06-679-2		
									06-368-4		
									15-469-10		
									15-469-3		
									15-469-4	INSULATOR (REAR)	1
									15-469-5		
									15-469-17		

PARTS LIST

MATERIAL	SCALE	SIZE B	DATE 03/25/2003	 5349 S. Enner Drive New Berlin, WI 53151 (888) 679-6170
FINISH	TOLERANCES UNLESS NOTED .XX = ± .03 .XXX = ± .010 ANGLES ± 1°	DRAWN A.L IPOWSKI	DESIGNED	
CAD GENERATED AND MAINTAINED DRAWING -- DO NOT SCALE			CHECKED <i>[Signature]</i> 11/02/2009	JACK, TNC CONNECTOR
NOTICE -- ALL CHANGES TO THIS DOCUMENT ARE CONTROLLED BY EMTEQ INC. / UNLESS OTHERWISE STATED, ALL REPRODUCTIONS OF THIS DOCUMENT ARE NOT CONTROLLED BY EMTEQ INC.			APPROVED T. FORST 01/11/2010	CAGE CODE 06WH3 DWG # TFSxxx-1 SHT 1 OF 1

FILE: TFSxxx-1.prt