

THIS DOCUMENT AND THE INFORMATION IT CONTAINS IS THE PROPERTY OF EMTEQ INC. AND MAY NOT BE USED IN ANY WAY WITHOUT THE EXPRESS WRITTEN CONSENT OF EMTEQ INC.

REV	REVISION	DATE	EN #	INTL
D	UPDATE SPECS & MECHANICAL INFO	06/22/2009	9853	LLP
E	ADD 125-075-1 OPTION	06/29/2009	9877	LLP
F	ADD FLAGNOTE 3	07/28/2009	9977	VML
G	CHANGE P/N OF ITEM 4, HEATSHRINK	10/29/2009	10252	VML
G01	ADD FLAGNOTE 4	03/10/2010	10635	VML
G02	CORRECT DIMENSION CALLOUTS "A" & "C"	08/03/2010	11111	LLP

DIMENSIONAL INFORMATION

PART NO.	"A"	"B"	"C"	ASS'Y INSTRUCTIONS
MBMS125-075-1	0.970 (24.6)	0.44 (11.2)	.175/.147 (4.45/3.73)	ES-105-59
MBMS175-075-1	0.924 (23.5)	0.44 (11.2)	.185 (4.7)	ES-105-55
MBMS190-075-1	0.924 (23.5)	0.44 (11.2)	.214 (5.44)	ES-105-55
MBMS275-075-1	0.970 (24.6)	0.44 (11.2)	.284 (7.21)	ES-105-59

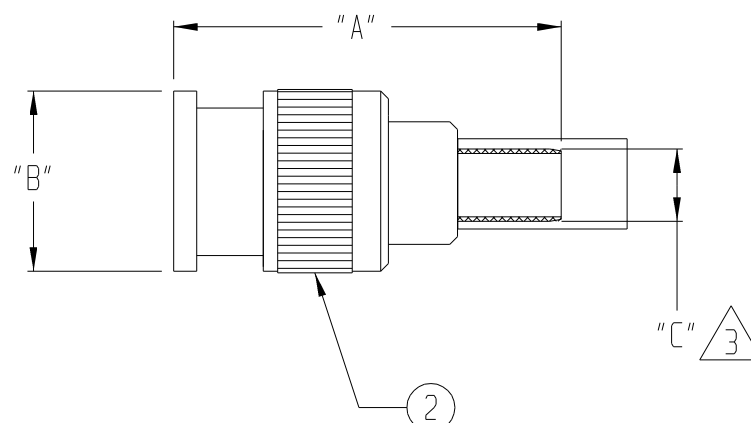

SPECIFICATIONS:

1) ELECTRICAL

IMPEDANCE: 75 OHMS
 FREQUENCY RANGE: 0 TO 2 GHZ
 VOLTAGE RATING: 300 V RMS
 DIELECTRIC WITHSTANDING VOLTAGE: 1,000 V RMS
 INSULATION RESISTANCE: 1,000 MEGOHMS MIN

2) MECHANICAL

TERMINATION STYLE: INNER CONTACT - SOLDER
 OUTER CONTACT - CRIMP
 TEMPERATURE RANGE: -40° C TO +85° C
 FINISHES:
 BODY FINISH: PROPRIETARY NICKEL
 CONTACT FINISH: GOLD PLATED PER MIL-G-45204

DESIGNED IN ACCORDANCE WITH MIL-C-39012 STANDARDS.

3 DIMENSION C IS TO BE AN INSIDE DIMENSION OF THE CRIMP TUBE.

4 THIS CONNECTOR DOES NOT USE A CRIMP TUBE. THE CRIMP TUBE COMES ALONG WITH THE BODY/CONTACT.

4		4		4	4	4
1	1	1	1	29-174-2	DURABLE HEATSHRINK	4
		1		29-100-49	CRIMP TUBE	3
	1			29-100-162		
1				60-233-3P	BODY/CONTACT	2
	1			60-233-2P		
		1	1	60-233-1P		
			1	15-469-19	INSULATOR(REAR)	1
1				15-469-26		
	1			15-469-11		
		1		15-469-6		
MBMS 275-075-1	190-075-1	175-075-1	125-075-1	PART NUMBER	DESCRIPTION	ITEM

PARTS LIST

MATERIAL	SCALE -	SIZE B	DATE 1/7/2009	EMTEQ 5349 S. EMMER DRIVE NEW BERLIN, WI 53151 (888) 679-6170
FINISH	TOLERANCES UNLESS NOTED .XX = ± .03 .XXX = ± .010 ANGLES ± 1°		DRAWN L. PACIGA	
CAD GENERATED AND MAINTAINED DRAWING -- DO NOT SCALE			DESIGNED	75 OHM MINI BNC CABLE PLUG, CRIMP
			CHECKED <i>[Signature]</i> 08/05/2010	
			APPROVED T. FORST 08/05/2010	CAGE CODE 06WH3
			DWG # MBMSXXX-075-1	
			SHT 1 OF 1	

NOTICE -- ALL CHANGES TO THIS DOCUMENT ARE CONTROLLED BY EMTEQ INC / UNLESS OTHERWISE STATED, ALL REPRODUCTIONS OF THIS DOCUMENT ARE NOT CONTROLLED BY EMTEQ INC

FILE: MBMSXXX-075-11.prt