

THIS DOCUMENT AND THE INFORMATION IT CONTAINS IS THE PROPERTY OF EMTEQ INC. AND MAY NOT BE USED IN ANY WAY WITHOUT THE EXPRESS WRITTEN CONSENT OF EMTEQ INC.

REV	REVISION	DATE	EN #	INTL
A00	RELEASE TO PRODUCTION	03/26/2010	10684	VML

## DIMENSIONAL INFORMATION

PART NO.	"A"	"B"	"C"	"D"	"E"	ASS'Y INSTRUCTIONS
MBMR125-075-1	1.06 (26.9)	0.901 (22.9)	0.38 (9.7)	0.56 (14.2)	0.093 (2.36)	TBD
MBMR175-075-1	1.06 (26.9)	0.901 (22.9)	0.38 (9.7)	0.56 (14.2)	0.118 (3.0)	TBD
MBMR190-075-1	1.06 (26.9)	0.901 (22.9)	0.38 (9.7)	0.56 (14.2)	0.159 (4.0)	TBD

### NOTES:

- 1 DIMENSION "E" IS MEASURED ON CONNECTOR BODY

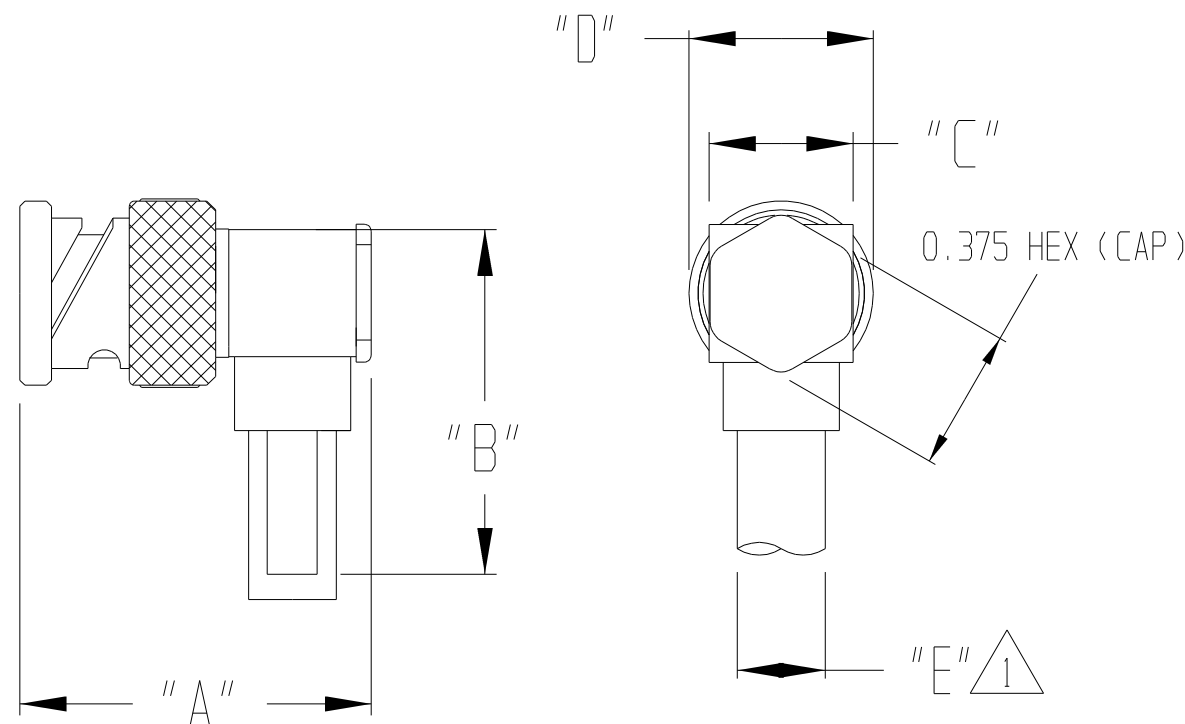

### SPECIFICATIONS:

- 1) ELECTRICAL  
 IMPEDANCE: 75 OHMS  
 FREQUENCY RANGE: 0 TO 4 GHZ  
 VOLTAGE RATING: 1,000 V RMS  
 DIELECTRIC WITHSTANDING VOLTAGE: 1,500 V RMS  
 INSULATION RESISTANCE: 5,000 MEGOHMS MIN
- 2) MECHANICAL  
 TERMINATION STYLE: INNER CONTACT - SOLDER  
 OUTER CONTACT - CRIMP  
 TEMPERATURE RANGE: -65° C TO + 165° C  
 FINISHES:  
 BODY FINISH: PROPRIETARY NICKEL  
 CONTACT FINISH: GOLD PLATED PER MIL-G-45204

DESIGNED IN ACCORDANCE WITH MIL-C-39012 STANDARDS.

1	1	1	29-174-2	O-RING	6	
1	1	1	29-174-2	DURABLE HEATSHRINK	5	
	1		29-100-49	CRIMP TUBE	4	
1			29-100-162			
1			09-21113	BODY/CONTACT	3	
	1		09-21112			
		1	09-21111			
1	1	1	07-164-2	CAP	2	
		1	15-469-19	INSULATOR( REAR)	1	
1			15-469-11			
	1		15-469-6			
MBMR	190-075-1	175-075-1	125-075-1	PART NUMBER	DESCRIPTION	ITEM

### PARTS LIST

MATERIAL	SCALE -	SIZE B	DATE 03/26/2010	 5349 S. EMMER DRIVE NEW BERLIN, WI 53151 (888) 679-6170
FINISH	TOLERANCES UNLESS NOTED .XX = ± .03 .XXX = ± .010 ANGLES ± 1°		DRAWN V. LEX DESIGNED CHECKED <i>[Signature]</i> 03/29/2010 APPROVED T. FORST 03/29/2010	
CAD GENERATED AND MAINTAINED DRAWING -- DO NOT SCALE			CAGE CODE 06WH3	DWG # MBMRXXX-075-1
NOTICE -- ALL CHANGES TO THIS DOCUMENT ARE CONTROLLED BY EMTEQ INC / UNLESS OTHERWISE STATED, ALL REPRODUCTIONS OF THIS DOCUMENT ARE NOT CONTROLLED BY EMTEQ INC				SHT 1 OF 1 FILE: MBMRXXX-075-1.prt